

North Country Master Gardener Volunteers Association 2022



Member Handbook

**University of Wisconsin-Madison, Division of Extension
Master Gardener Volunteer Program**

Our goal shall be to encourage, foster, support and promote horticulture for all residents of Burnett, Sawyer and Washburn Counties; and to promote the University of Wisconsin-Madison, Division of Extension from which we are founded.

2022 Schedule of Events

See the NCMGVA website for more events and details at:

<http://www.northcountrymgv.org/>

NCMGVA Monthly Meetings (4th Thursday),

5:30 pm Subject to change—check website

NCMGVA Officers

President Vacant 9/30/22

Vice-President Jill Fries- Term expires 9/30/22

Secretary Deb Studley – Term expires 9/30/22

Treasurer Jill Schmalz-Washkuhn - Term Expires 9/30/23

Directors

Linda Anderson – Term expires 9/30/23

Jessie Crane – Term expires 9/30/22

Donna Amidon – Term expires 9/30/23

WIMGA Representative

Director-at-large: Janet Mangold

Local Rep: Open

District Board Member: Roseann Meixelsperger

Wisconsin Master Gardener Association (WIMGA)

Marilyn Gorham, President

Website: www.wimga.org

**North Country Master Gardener Volunteers Association by-laws are
online at: www.northcountrymgv.org/members**

Abbreviations and acronyms used in this booklet:

- AAS — All-America Selections
- MGVA — Master Gardener Volunteers
- NCMGVA—North Country Master Gardener Volunteers Association
- SARS Building—Spoooner Agricultural Research Station Building
- SARS Garden— Spoooner Agricultural Research Station, Teaching & Display Garden

Communications

University of Wisconsin-Madison Contacts

Kevin Schoessow

UW Extension Area Agriculture Development Educator

Spooner Agricultural Research Station

1036 E Maple Street, Spooner, WI 54801

Kevin.schoessow@wisc.edu

Phone: 715-635-3506 or 1-800-528-1914

Fax: 715-635-6741

Lorraine Toman, Office Manager

Phone: 715-635-3735

lorraine.toman@wisc.edu

State Master Gardener Program

University of Wisconsin – Madison, Dept of Horticulture

1575 Linden Drive, Madison, WI 53706

Phone: (608) 265-4536 Fax: (608) 262-4743

Jay Dampier & Kimberly Miller

For all State Program Office communications send emails to:

wimastergardener@extension.wisc.edu

(delivered to both Jay and Kimberly)

Communicating with Volunteers & Other Gardeners

Active Master Gardener Volunteers - this group email of members MGcontacts2022@g-groups.wisc.edu can be used by any member whose name is listed in this directory.

Google Groups Email List - is maintained by Lorraine Toman to communicate with current or former members of the NCMGVA, MGVA trainees or former trainees. The email will reach about 100 gardeners associated with NCMGVA.

Community List - Lorraine Toman maintains an email list of community members who are interested in our programs. This list contains over 400 emails and can be used to promote events and provide information to the wider community. Contact Lorraine for distribution to this list.

(Please send handbook corrections to Sue Reinardy sreinardy74@gmail.com)

Volunteer Project Descriptions

There are many ways for volunteers to contribute. This is a sampling of the various volunteer activities of NCMGVA.

Children and Youth Programs:

- **School & Gardens:** Provide leadership and support to schools interested in horticulture & gardens (Locations: Spooner, Shell Lake, Webster, Hayward, etc)
- **Mini Master Gardeners:** Half-day educational programs provided to youth (Mini-Masters , Home School, or Family Fest)
- **Children's Garden:** Assist with hands-on, educational sessions with children, ages 3 to 12, bi-monthly from mid-June to mid-August at the Teaching & Display Garden.

Communications to Public & Members: Provide input to Member Handbook, Website & Blog.

Horticulture Inquiries: Listen, probe, record, research and respond to the public's horticultural questions and concerns, and demonstrate available resources. Onsite, at Farmers Markets, or phone/email inquiries.

May Plant Sale: Activities include seed starting, signage, planning, procuring, marketing, preparing materials, setting-up, clean-up, collecting monies & assisting the public during the sale.

Seed Starting, Saving & Plant Maintenance: Perform germination tests on older seed, when applicable, and procure new seed from established sources. Develop schedules for all seed starting, pot cleaning, transplanting and maintenance, e.g., watering, fertilizing, hardening off, harvesting, etc. Save seed from selected open-pollinated plant specimens grown at the Teaching & Display Garden to maintain varieties offered at the annual plant sale and other MG horticultural needs.

Speakers Bureau: Speak on educational/horticultural subjects, which may include seminars, hands-on activities and informal/formal presentations.

Volunteer Project Descriptions

Publicity/Marketing/Signage: Each committee manages its own needs and coordinates with others.

Wisconsin Master Gardener Association (WIMGA): Attend two meetings a year as our representative to the Statewide Association, participate in committees, assist in district-wide communications and provide WIMGA required information and documents.

Teaching & Display Garden: Participate in the educational demonstrations and tours throughout the Garden, including the All-America Selections ornamental & edible plants, Monarch and Pollinator Sanctuary (MAPS) aka perennial garden, Sensory Garden, and Children's Garden. Assist with planning, planting, maintaining, harvesting & promoting.

- **Overall Planning:** Participate in the overall planning of the Teaching & Display Garden.
- **All-America Selections:** Plan the garden beds and assist with planting/maintaining the AAS edible & ornamental plants. If participating in the annual design contest, manage that process.
- **Monarch & Pollinator Sanctuary:** Plan/review layout of the perennial garden and assist with maintenance.
- **Education:** Participate in the planning and programming of an adult educational series offered in the Garden.
- **Twilight Garden Tour:** Plan and participate in an August event, featuring educational speakers, booths, food tastings, which attract 300 visitors.
- **Groups Tours and Visits:** Plan event, guide groups and provide information.



TEACHING AND DISPLAY GARDEN 2021

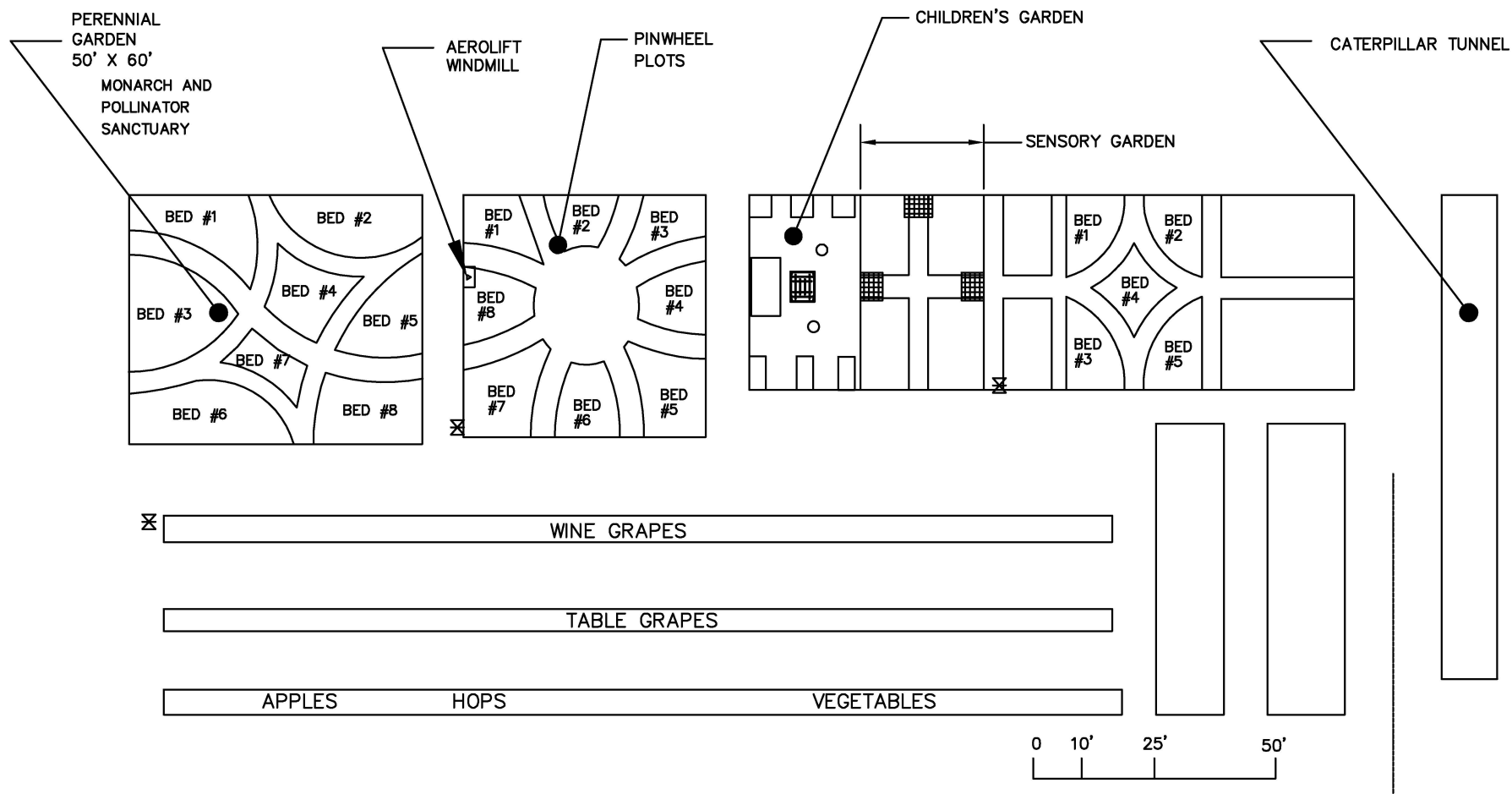

Contact information has been deleted.
Please contact Sue Reinardy at sreinardy@centurytel.net for information.

Volunteer & Continuing Education Hours

Our reporting period is on a calendar year basis, January to December. To understand the new participation levels, please refer to the Onboarding Course in the UW Canvas Classroom where you'll be able to find the most up-to-date information relating to the Extension Master Gardener Program. Go to the Toolbox at: <https://mastergardener.extension.wisc.edu/toolbox/>

Online reporting system

<https://wimastergardener.org/report-your-hours/>

Volunteer Hours Requirements

In 2022 Master Gardeners will go back to the standard requirements: minimum of 24 volunteer hours and 10 hours of continuing education. This plus completing all the volunteer mandates will be required to certify next year.

If you will be volunteering for the UW-Extension in areas and activities such as the Teaching and Display Garden or Horticulture inquires you will need to agree with the position description, be up-to-date on background checks and Mandated Reporter training. More detailed information will be available online at: <https://www.northcountrymgv.org/onboarding.html> for UW Extension volunteer enrollment at or call Kevin Schoessow at the Spooner Agriculture Research Station.

December 31, 2021 is the deadline to complete and report your hours in the online reporting system.

See the State Program Website for frequently asked questions on Master Gardener Volunteer requirements: https://docs.google.com/document/d/1_xYjjiMJQvdV_I6NeatTP3-BIVnY1psWoCwALwuLvgs/edit#

If you have at least 1 hours of CE or volunteer hours, you will be considered Active (but not Certified for the next year.) If you do not report any hours, you will be considered Inactive. If you wish to return, please review the following criteria and contact the Master Gardener Program office.

- Once deactivated, you have up to 5 years since last being Active/Certified to return to the program (with the requirement of completing Onboarding-lite (no exam, no fee).
- If returning after 5 years of absence, you must re-enroll and complete Onboarding (take exam and pay fee). You will return with a participation level of Inactive. The hours you report into the ORS by December 31 will determine your participation level for the following year.

Online Links

North Country Master Gardener Volunteers

www.northcountrymgv.org

Spooner Agricultural Research Station Website

spooner.ars.wisc.edu/demonstration-garden/

Spooner Agricultural Research Station Facebook Page

www.facebook.com/spoonerag

University of Wisconsin-Madison

Division of Extension, Master Gardener Program

wimastergardener.org

Wisconsin Master Gardener Association (WIMGA)

www.wimga.org

A comprehensive schedule of events throughout the state and region can be found on the Wisconsin Master Gardener Program webpage: www.wimastergardener.org

